

12V WIFI+IR RGB dream color string downlight

12V WIFI+IR RGB dream color string downlight

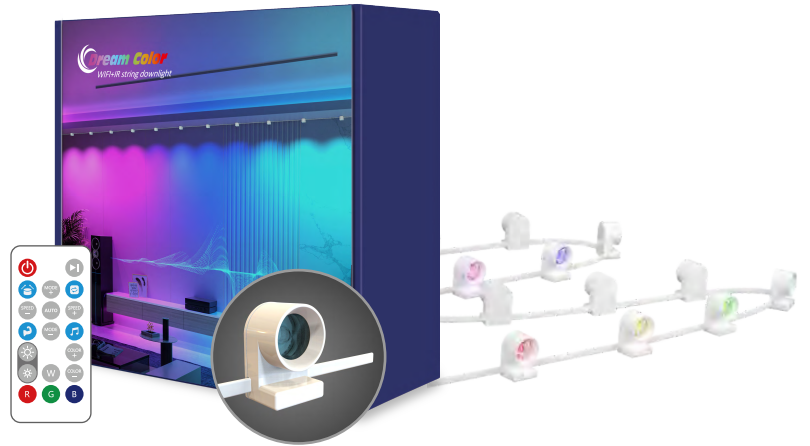

Product function

- Using precision optical design, beam + wall wash light effect
- Using high brightness LED beads, be used for auxiliary lighting
- RGB16 million colours, even light, streaming colour
- WIFI + Bluetooth communication, APP and remote operation
- Multiple control modes, support button, remote control operation
- Support the music rhythm function, the light follows the music changes, sound and light synchronisation
- Support DIY settings, there are a variety of scenarios, colour, brightness optional
- Support timer, countdown, friend sharing and memory functions.
- Tail end with waterproof adapter, support for extension cables, support for multi-string connection



APP function

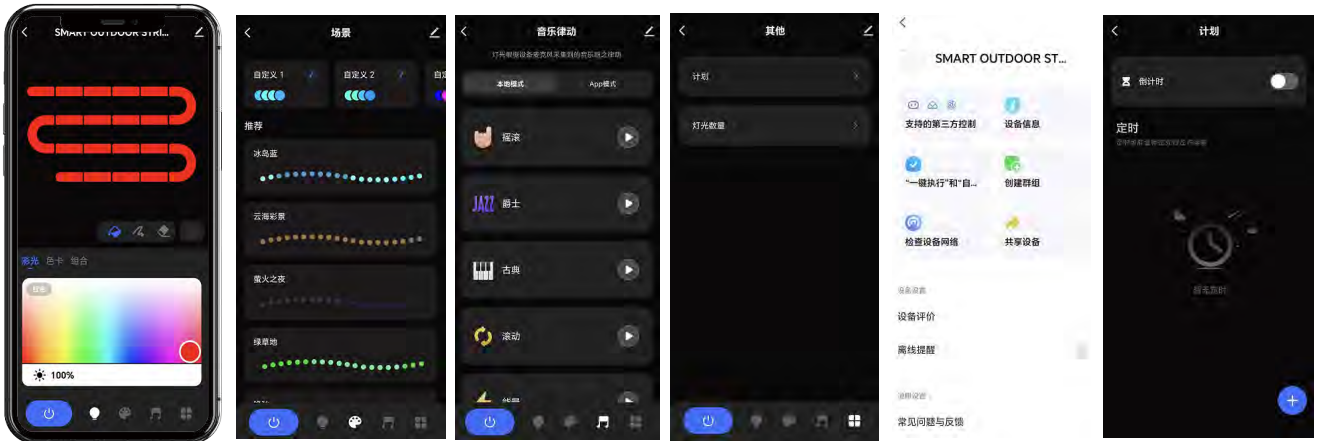

Remote control function

Button cell battery power supply, 3V working voltage. Control distance: 5-8 meters in open area. 19-keys IR remote can realize various dream color lighting effects and various music modes.

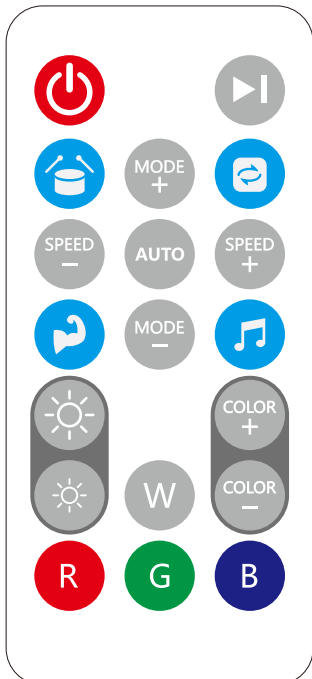

Features	action	Remote control buttons
Turn on/off	press	
Music mode pause/start	press	
Speed/sensitivity	press	
Dynamic mode switching	press	
Music mode	press	
Automatic mode	press	
Brightness adjustment	press	
Static color switching	press	
W R G B	press	

Product Connections

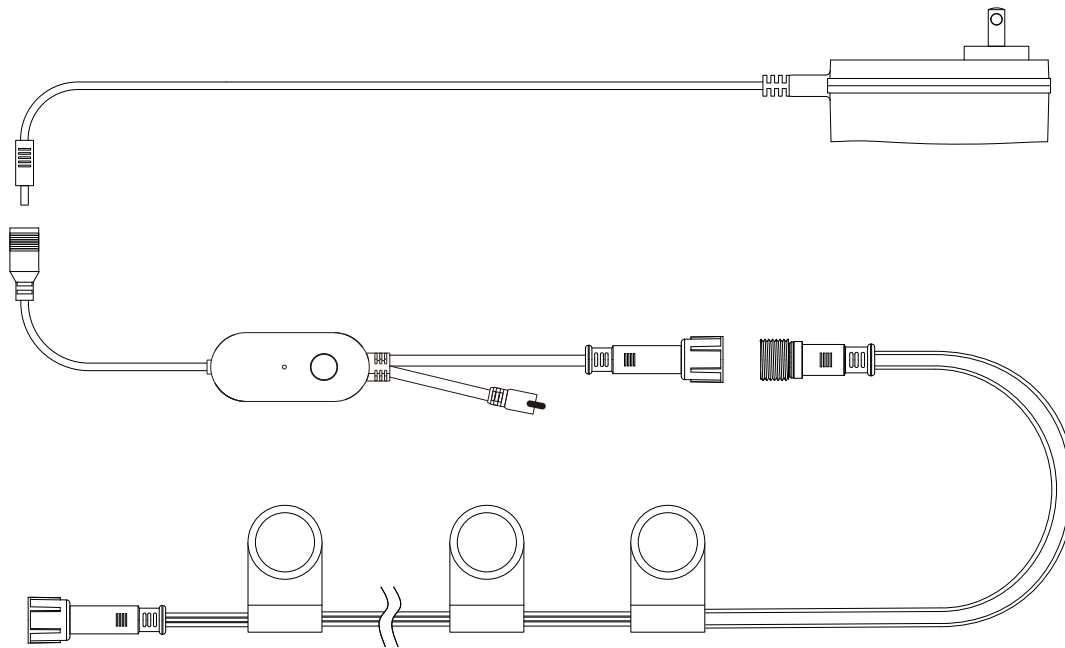

Product Installation

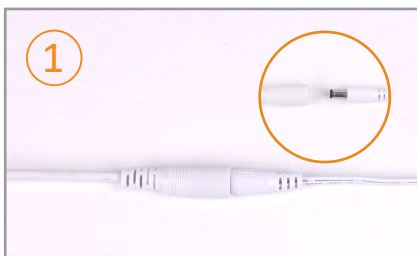

1 Connect the adapter and the control box



2 Wipe the surface and make sure it is clean and dry



3 Tear off the protective film of the VHB gum



4 Press the VHB gum against the surface firmly

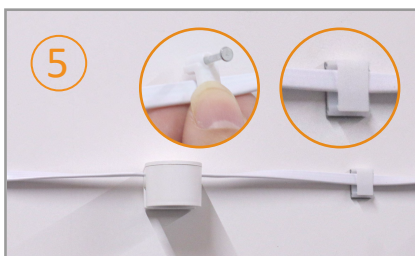

5 Secure the power cord with snap or staple clips

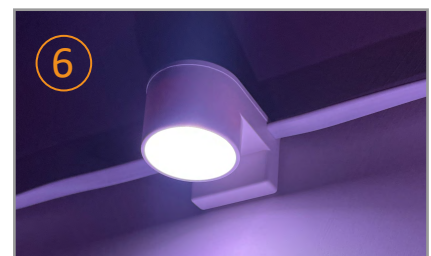

6 Enjoy the string downlight

Applications: widely used for decorative lighting for living room and gaming room etc.,.



Product parameters

Model No.	SNDGY-210	SNDGY-315	SNDGY-512	SNDGY-525
Name	2m 10 LEDs	3m 15LEDs	5m 12LEDs	5m 25LEDs
Surface Technology	ABS+PC			
Remote distance	≤5M			
Communication	WIFI+BLE			
Voltage	DC 12V			
Single string power	8W	12W	9.6W	20W
Max. number of strings	4 strings 8m	3 strings 9m	3 strings 15m	1 strings 5m
Max. power	40 LEDs/32W	45 LEDs/36W	36 LEDs/28.8W	25 LEDs/20W
Number of Lamps	10 LEDs	15 LEDs	12 LEDs	25 LEDs
LEDs	5050RGB			
Beam Angle	120°			
Control method	Push button, APP, infrared, voice			
Installation	Adhesive backing+Clip			
IP rate	IP20			
Working temp	-10 ~ 40°C			

Packing list

Name	2m 10 LEDs	3m 15LEDs	5m 12LEDs	5m 25LEDs
power adapter(12V)	12W × 1	12W × 1	12W × 1	24W × 1
Remote control	1	1	1	1
velcro	1	1	1	1
Power cord snap (with adhesive backing)	1	1	1	1
Lamp Body Cord Snap (with adhesive backing)	5	8	6	13
Lamp Body Wire Snap (with adhesive backing)	5	8	6	13
Manual	1	1	1	1
PE bag	1	1	1	1

Note: 1, the power supply, remote control, card buckle class all packed in the accessories box
2, before shipping, the lamp body has been affixed with good adhesive backing